



N-Type ABC Mono-glass Module

AIKO-A-MAH72Mw

Up to **24.2%**
600W-625W



Product
Warranty



Performance
Warranty



reddot winner 2023

Premium Appearance

No grid lines on the front

Higher Power Output

Higher efficiency: 23.9%

Lower degradation: 1 year $\leq 1.0\%$, 2-30 year $\leq 0.35\%$

Better temperature coefficient: $-0.26\%/^{\circ}\text{C}$

Optimized Balance of System (BOS)

Significant savings on mounting structure, cabling, and labour cost

Complete Set of Quality Management System

IEC 61730 (2016) IEC 61215 (2021)

ISO 9001:2015 Quality Management System

ISO 14001:2015 Environmental Management System

ISO 45001:2018 Occupational Safety and Management System

(Made in China)



625W
Output

24.2%
Efficiency

≤1%
First-year Degradation

≤0.35%
Annual Degradation from Year 2-30

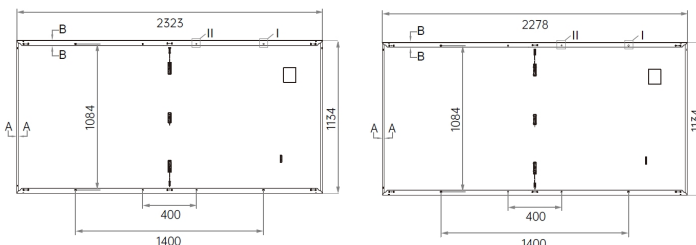
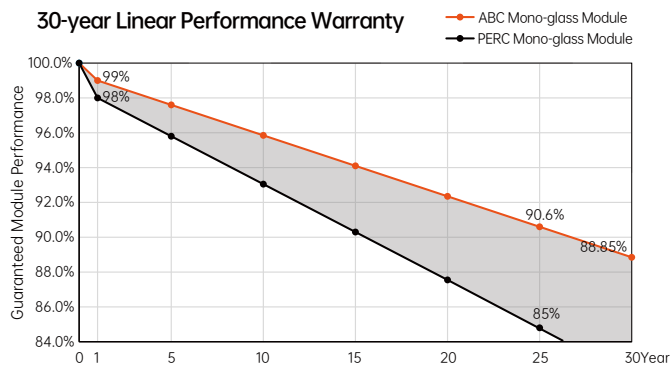

Tolerance
L: ±2mm
W: ±2mm
Unit: mm

Electrical Characteristics (STC: AM1.5 1000W/m² 25°C NOCT: AM1.5 800W/m² 20°C 1m/s)

Power Tolerance: ±3%

Model	AIKO-A600-MAH72Mw	AIKO-A605-MAH72Mw	AIKO-A610-MAH72Mw	AIKO-A615-MAH72Mw	AIKO-A620-MAH72Mw	AIKO-A625-MAH72Mw
Test Conditions	STC	STC	STC	STC	STC	STC
P_{max} [W]	600	605	610	615	620	625
V_{oc} [V]	53.99	54.09	54.19	54.29	54.39	54.49
V_{mp} [V]	44.68	44.78	44.88	44.98	45.08	45.18
I_{sc} [A]	14.20	14.28	14.36	14.44	14.52	14.60
I_{mp} [A]	13.44	13.52	13.60	13.68	13.76	13.84
Module Efficiency	22.8%/23.2%	23.0%/23.4%	23.2%/23.6%	23.3%/23.8%	23.5%/24.0%	23.7%/24.2%

Mechanical Specification

Cell Type	N-Type ABC
Front Cover Mono glass	3.2 mm tempered glass
Frame	Anodized aluminum
Cable	4mm ² (IEC) 12AWG(UL) 350mm or Customized Length
No. of Cells	144(6*24)
Junction Box	IP68, three bypass diodes
Connector	MC4 EVOA/MC4 EVO2
Weight	29/28.2kg±3%
Dimension	2323*1134*35/40mm、2278*1134*35/40mm
Package Detail	31pcs per pallet/155 pcs per 20' GP/620pcs per 40' HQ

Temperature Ratings (STC)

Temperature Coefficient of I_{sc}	+ 0.05%/ °C
Temperature Coefficient of V_{oc}	- 0.22%/ °C
Temperature Coefficient of P_{max}	- 0.26%/ °C

Installation Guide

Operation Temperature	- 40°C-+85°C
Maximum Series Fuse Rating	25A
Protection Class	Class II
V_{oc} and I_{sc} Tolerance	±3%
Maximum System Voltage	DC1500V
Maximum Static Loading	Front 5400Pa Back 2400Pa
Hail Test	25 mm diameter hail at 23 m/s
Fire Rating	IEC Class C